

GJL International Technology & Trading, Inc.

GC IV-2"62-QLEMC/2-1/8

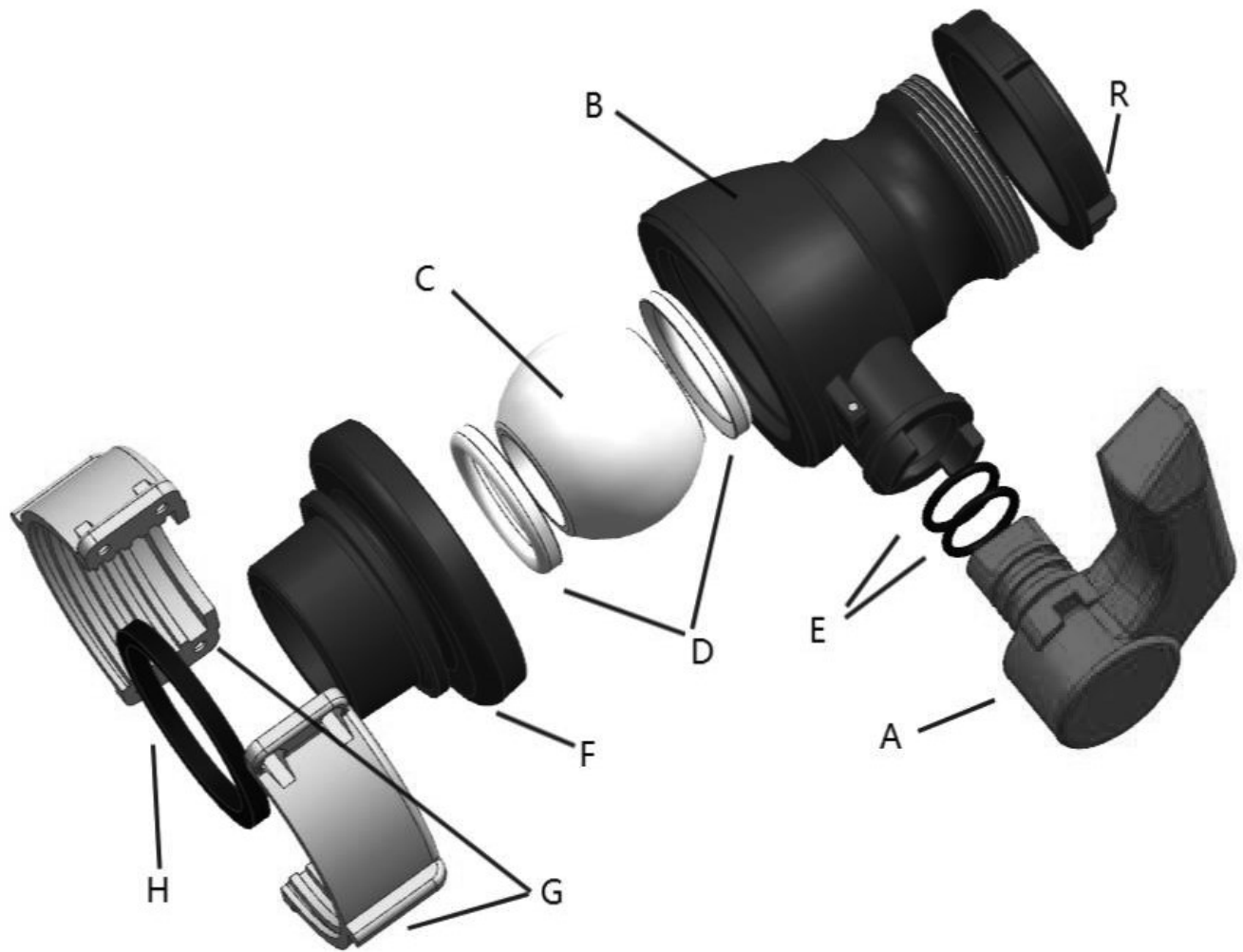

QC:

1- All valves are subjected to and must pass compressed air test to hold air internally for 3 hrs.

2- A sampling of valves (min. 10 from each run) are subjected to the following:

Inner Stress Test Drop Test
Leakproof Test Vibration Test

Torque:
80-90 ft lb

GC IV-2"62-QLEMC/2-1/8
62mm Aluminum Collar Ball Valve
2-1/8" QD Outlet
LDPE Ball Seals
Collar VITON Gasket
Shallow Dust Cap Attached

Part	QTY	Name	Material	OD	ID
A	1	Handle	PP GF30		
B	1	Valve Body Upper	PP Copolymer	2.42"	1.425"
C	1	Ball	PP		
D	2	Ball Seal	LDPE		
E	2	O-Ring	EPDM and Viton		
F	1	Valve Body Lower	PP		
	not shown1	Gasket	LDP		
G	1	Collar (2 pc assembly)	Aluminum Alloy		
H					
R					
	not shown1	Shallow Dust Cap	PE		