

GJL International Technology & Trading, Inc.

GC IV-2"62-QLLMC/2-1/8

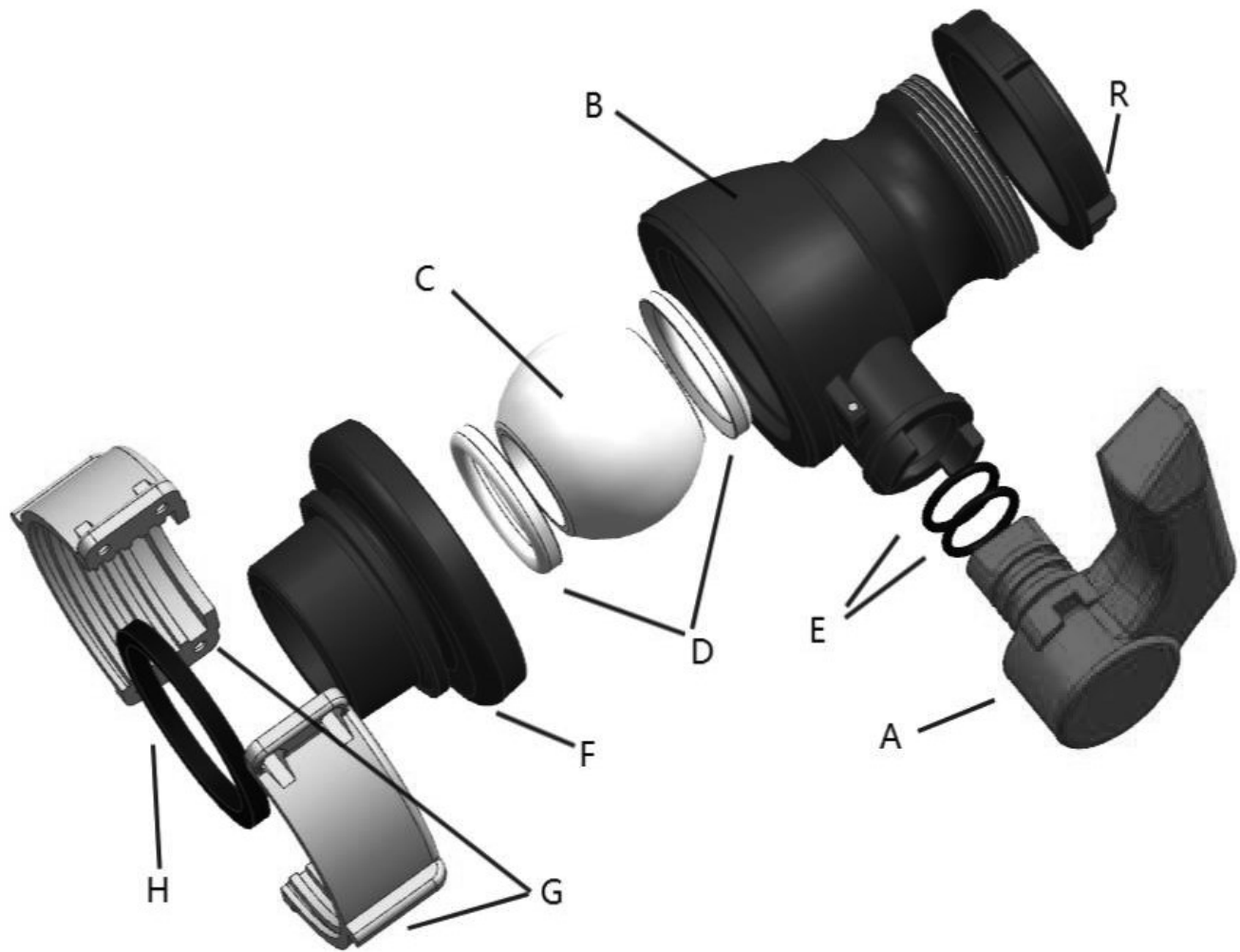

QC:

1- All valves are subjected to and must pass compressed air test to hold air internally for 3 hrs.

2- A sampling of valves (min. 10 from each run) are subjected to the following:

Inner Stress Test Drop Test
Leakproof Test Vibration Test

Torque:
80-90 ft lb

GC IV-2"62-QLLMC/2-1/8
62mm Aluminum Collar Ball Valve
2-1/8" QD Outlet
LDPE Ball Seals
Collar LDPE Gasket
Shallow Dust Cap Attached

| Part | QTY | Name | Material | OD | ID |
|------|-----------|------------------------|----------------|-------|--------|
| A | 1 | Handle | PP GF30 | | |
| B | 1 | Valve Body Upper | PP Copolymer | 2.42" | 1.425" |
| C | 1 | Ball | PP | | |
| D | 2 | Ball Seal | LDPE | | |
| E | 2 | O-Ring | EPDM and Viton | | |
| F | 1 | Valve Body Lower | PP | | |
| | not shown | Gasket | LDPE-OBC | | |
| G | 1 | Collar (2 pc assembly) | Aluminum Alloy | | |
| H | | | | | |
| R | | | | | |
| | not shown | Shallow Dust Cap | PE | | |
| | 1 | | | | |