

**GJL International Technology & Trading, Inc.**  
**GC IV-2"75-QLLMC/2-1/8**

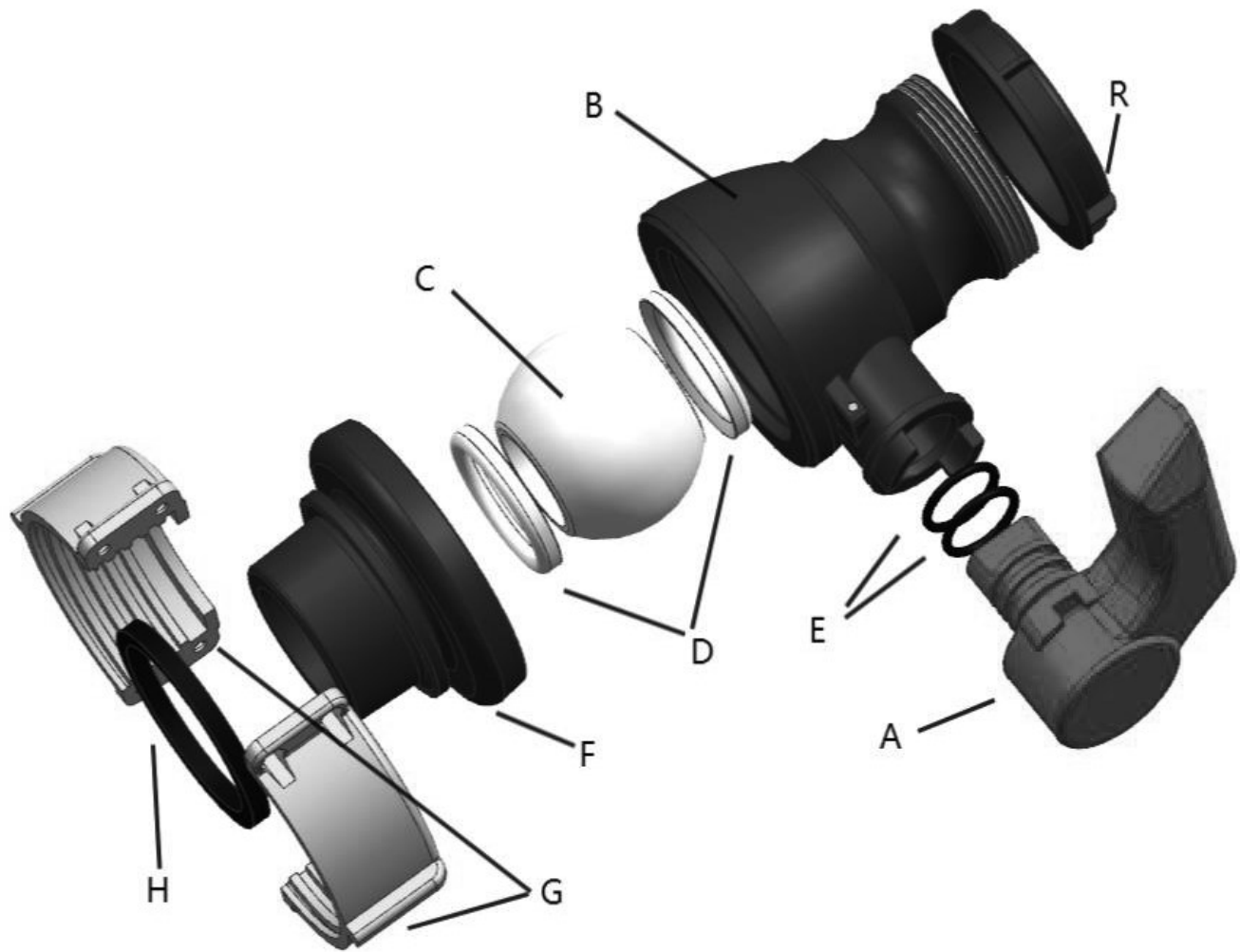

**QC:**

1- All valves are subjected to and must pass compressed air test to hold air internally for 3 hrs.

2- A sampling of valves (min. 10 from each run) are subjected to the following:

Inner Stress Test Drop Test  
 Leakproof Test Vibration Test

Torque:  
 80-90 ft lb

GC IV-2"75-QLLMC/2-1/8  
 75mm Aluminum Collar Ball Valve  
 2-1/8" QD Outlet  
 LDPE Ball Seals  
 Collar LDPE Gasket  
 Shallow Dust Cap Attached

Part	QTY	Name	Material	OD	ID
A	1	Handle	PP GF30		
B	1	Valve Body Upper	PP Copolymer	2.42"	1.425"
C	1	Ball	PP		
D	2	Ball Seal	LDPE		
E	2	O-Ring	EPDM and Viton		
F	1	Valve Body Lower	PP		
	not shown	Gasket	LDPE-OBC		
G	1	Collar (2 pc assembly)	Aluminum Alloy		
H					
R					
	not shown	Shallow Dust Cap	PE		
	1				